



Lithium Sulfur Dioxide Battery Brief Datasheet Model: WR34615

1. Basic Specification (Typical values relative to cells stored for one year or less at +30°C Max.)

Item	Parameters	Remark
Model	WR34615	
Nominal Capacity(mAh)	7800	at 2mA ±23°C, 2.0V cut off
Nominal Voltage(V)	2.9	Operating vol. 2.5v to 2.8v
Maximum recommended continuous current(mA)	4000	
Maximum recommended pulse current(mA)	6000	
Operating temperature range(°C)	-55~+65	
Storage temperature(recommended)	+30°C Max.	
Size(Diameter x Height mm*mm)	34 x 61.5	
Weight(g)	90	
Customized a variety of JST/MOLEX/ORTHER/WURTH etc. connector, terminal, welding feet. Pleases contact HJBP.		

2. Electrical Characteristics and Dimension(20 ± 2 °C)

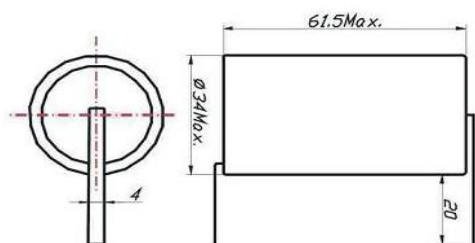
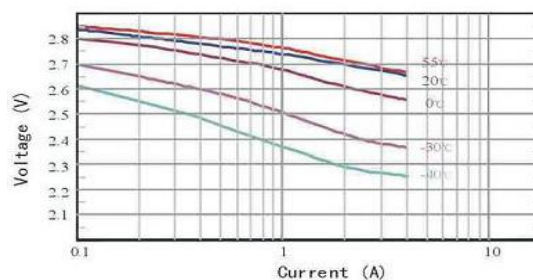
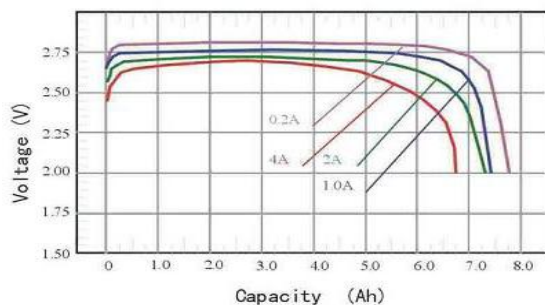

S: Standard terminations; T: Solder tabs; P: Axial pins. **Special termination are available upon request.**

3. Benefits

- ★High discharge current at low temperature application.
- ★Energy density, 330Wh/Kg
- ★Stable voltage with open circuit voltage greater than 2.9V and operating voltage 2.5V to 2.8V.
- ★Wide range of operating temperature(-50°C~+75°C)
- ★Long self life (over 10 years at normal room temperature)
- ★UL/CE certification, MSDS/SGS/ROHS test reporter, ISO19001 quality control system

4. Main applications

- ★Intelligent Instrument and meter
- ★Memory and standby power
- ★Alarms and security devices,
- ★Automotive electronic
- ★Electronic toll collection
- ★Military devices.

5. Warning

- *Please keep away Fire, explosion and server burn hazard.
- *Please do not recharge, crush, disassemble, heat above 100°C.
- *Please do not solder directly to cell. Do not short circuit.

Note: Any representations in this brochure concerning performance, are for informational purposes only and are not construed as warranties either expressed or implied, of future performance.