



Lithium Manganese Dioxide Battery Brief Data Sheet Model: CR9V

1. Basic Specification (Typical values relative to cells stored for one year or less at +30°C Max.)

Item	Parameters	Remark
Model	CR9V	
Nominal Capacity(mAh)	1200	at 1mA ±23°C, 6.0V cut off
Nominal Voltage(V)	9.0	
Open-circuit Voltage(V)	≥9.3V	
Standard discharge current (mA)	1mA	
Maximum continuous current(mA)	300mA	Discharge Capacity more than 50%
Maximum pulse current(mA)	500mA	Pulse discharge, maintained 3s, standby 27s, discharge capacity more than 50%
Operating temperature range(°C)	-40~+60	
Self-Discharge rate per year	<2.0%.	
Weight(g)	39.0	

Customized a variety of JST/MOLEX/ORTHER etc. connector , terminal. More information, Please contact HJBP power engineer.

2. Electrical Characteristics and Dimension

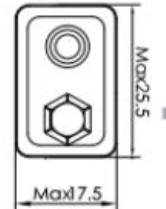
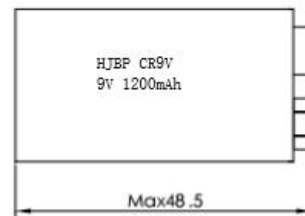
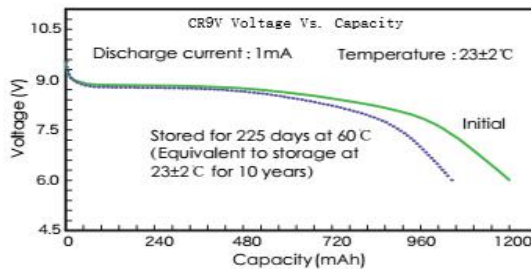
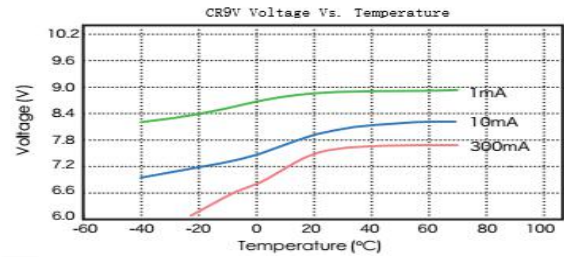
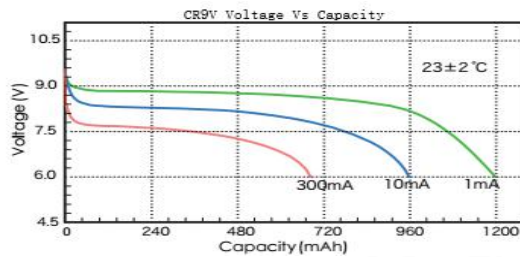

3. Key feature

- ★ High Safety.
- ★ Energy Density up to 450Wh/kg
- ★ CE/UN38.3 certificate, MSDS/ROHS test reporter, meet UL certificate, ISO19001 quality control system
- ★ Non-flammable electrolyte
- ★ No Passivation
- ★ Long Shelf Life

4. Main applications

- ★ GPS tracking system
- ★ Smart Metering/Home devices
- ★ Internet of Things
- ★ RFID devices
- ★ Ups data recording
- ★ Security system
- ★ Medical devices
- ★ Wireless transmitting

5. Warning

- *Please do not Fire, explosion and severe burn hazard.
- *Please do not recharge, crush, disassemble, heat above 100°C.
- *Please do not use upside down cell.
- *Please do not solder directly to cell.

Note: Any representations in this brochure concerning performance, are for informational purposes only and are not construed as warranties either expressed or implied, of future performance.